

# Stuart Pea

October 2023



## Emergency Numbers

After hours GP Helpline

1800 022 222

Community Health

(08) 9031 1311

Crisis Care (free call)

1800 625 800

Department of Child Protection

(08) 9088 2900

### **Doctor's Surgery**

(08) 9031 1093

### **One Tree Women's Crisis Centre**

(08) 9031 1899

Laverton Shire

0429 165 381

## Police, Ambulance, Fire & Rescue

000 or 112 (mobile)

Health Direct

13 23 51

Hospital

(08) 9088 2600

Horizon Power

13 23 51

Police

(08) 9088 2777

Poisons Information

13 11 26

Royal Flying Doctor Service  
(emergencies only)

1800 625 800

Water Corporation

13 13 75

## Accommodation

Desert Inn Hotel

(08) 9031 1188

Laverton Chalet/Motel

(08) 9031 1130

The Outback way Hideaway self  
contained apartments

0499 083 494

## Airport

Airport Manager

049 725 544

## Building Services & Construction

Steve Ripps Carpentry

0400913258

## Café/Fast Food/Pub

Desert Deli

0498 215 116

Great Beyond Visitor Centre

(08) 9031 1361

Desert Inn

(08) 9031 1188

## Children's Services

Story & Rhyme Time

(08) 9031 1800

Youth Centre - Contact Shire of  
Laverton

(08) 9031 1202

## Earth Works

C&A Taylor Grading

0427 819 564

Desert Sands Cartage Contractors

(08) 9031 1326

## Education

Cosmo Newberry School

(08) 9037 5943

Laverton Kindergarten

(08) 9031 1020

Laverton School

(08) 9031 1020

Mt Margaret School

(08) 9037 5959

Mulga Queen School

(08) 9031 3300

## Electrical and Refrigeration

AS Refrigeration

(08) 9031 1221

Powerchill

0417 951 153

PWT Electricians

0438 444 962

Auto Electrical Repairs & Air  
Conditioning

0408 092 332

Multiple Trades & Maintenance

9378 3395

## Funeral Directors

Goldfields Funeral Directors

9021 2023

## Freight

Laverton Freight Yard

0488 717 628

## Justices of the Peace

Mrs Shaneane Marjorie Weldon

0458745391

Mr Robert Martin Wedge

0417 951 153

## Public Transport

Gold Rush Tours

1800 620 440

## Mining/Exploration

Goldfields Australia-Granny Smith  
Mine

(08) 9088 2105

Sunrise Dam Gold Mine

(08) 9080 3765

Murrin Murrin Mine Site

(08) 9212 8400

Windarra Mine Site

(08) 9031 1611

Lynas Corporation Mt Weld

(08) 9031 1645

Gruyere Project, Yamarna

(08) 9037-5963

Dacian Gold, Mt Morgans Gold Operation  
(08) 6323 9100

## Pest Control

Mobile Pest and Weed Control  
(08) 9093 2809

## Post Office

Laverton Post Office  
(08) 9031 1101

## Recreation Clubs

Laverton Gym—Contact Shire of Laverton  
(08) 9031 1202

Laverton Race Club  
0417 951 153

Laverton Sports Club Inc.  
(08) 9031 1220

Laverton Sporting Shooters Association  
0418 935 518

## Recycling

Great Central Recycle  
0437 877 837

## Religion

The Church of The Resurrection -  
**Fr Robert O'Bryan**  
0457980852

LA Outback Church  
0433 392 511

Pastor Mark Pedder—Registered Marriage  
Celebrant  
0484 317 426

## Service Station/Mechanic

Laverton Motors  
(08) 9031 1210

Laverton Auto Electrics -Mechanical  
Repairs and Tyre Services-fully licensed  
repairer.  
0408 092 332

## Shire of Laverton

Reception

(08) 9031 1202

Great Beyond Visitor Centre  
(08) 9031 1361

Laverton Community Resource  
Centre/Library  
(08) 9031 1800

Laverton Aquatic Centre  
0499 299 241

## Shire Councillors

President Cr. Patrick Hill  
0419 925 371

Deputy President Cr. Shaneane  
Weldon  
0458 745 391

Cr. Gary Buckmaster  
0427 476 474

Cr. Jack Carmody  
0488 581 729

Cr. Robin Prentice  
0409 311 442

Cr. Robert Wedge  
0417 951 153

Cr. Rex Weldon  
0427 348 516

## Shopping

Laverton Supermarket  
(08) 9031 1675

## Tourist/Recreation

Laverton Outback Gallery  
(08) 9031 1395

Great Beyond Visitor Centre  
(08) 9031 1361

## Pastoral Properties

Banjawarn Station

(08) 9037 5977

Bandya Station  
(08) 9031 3727

Delita Station  
(08) 9037 5954

Erlistoun Station  
(08) 9031 3954

Lake Wells Station  
(08) 9037 5962

Laverton Downs Station  
(08) 9037 5998

Minara Station  
(08) 9037 5966

Mt Weld Station  
0438 188 769

Prenti Downs Station  
(08) 9981 2111

0488 581 729

White Cliffs Station  
(08) 9037 5950

Wonganoo Station  
(08) 9037 5942

Yamarna Station  
(08) 9037 5963

If you wish to add your number  
to this list, or you do not wish  
to be listed, please contact the  
Laverton Community Resource  
Centre.

(08) 9031 1800

crcassist@laverton.wa.gov.au



## Employment Opportunities

The Council is always looking for staffing in many areas including current vacancies as follows.

- ✓ Traineeships, in the Swimming Pool, Parks and Gardens, Administration, Roadworks, etc
- ✓ Community Development Co-ordinator
- ✓ Tourism Officer
- ✓ Community Resource Centre Assistance
- ✓ Youth Development Officers

The council is keen to find people who fit into the Laverton Community and appreciate a challenge in your work and a comprehensive training program to the right applicants in all these roles. The roles can be part time or full time depending upon the requirements of the applicant.

An appropriate remuneration package will be discussed with the successful applicant including a competitive salary, superannuation, housing allowance etc.

Please contact Tamara Hill (90311202) at the council administration office should you have any questions or would like assistance with your resume.

Please send through your resume or letter of interest to.

Tamara Hill  
Executive Assistant  
Shire of Laverton  
9 Macpherson Street  
Laverton WA

## **LOCAL GOVERNMENT ELECTION**

### **Early voting in person for the ELECTION to be held on Saturday 21ST OCTOBER 2023**

Under the *Local Government Act 1995*, we hereby give public notice the Ordinary Local Government Election will be held on Saturday 21st October 2023 in the Shire of Laverton Council Administration Offices, 9 Macpherson Place to fill four (4) vacancies.

Candidates are.

Jack Carmody  
Rex Weldon  
Robin Prentice  
Teresa Johnson  
Paul Ovans  
Brandon Conway-Cox  
Kim Mancktelow  
Mark Pedder  
Lucas Conway-Cox  
Gary Buckmaster

Early voting will commence Wednesday 4th October 2023 between the hours of 8.30am to 4.30pm Monday to Friday, and close Friday 20th October 2023.

Please do not hesitate to contact Tamara Hill on (08) 9031 1202 should you have any questions or need assistance.

**SHIRE OF LAVERTON**





### **TOWN BEAUTIFICATION**

The Shire of Laverton would like to inform residents of the progress and upcoming town beautification, projects being undertaken along road projects for the 2023/2024 financial year.

Please do not hesitate to contact either your Councillors or the Administration Office should you have any questions.

The Council is committed to the town development and putting in place infrastructure to ensure that Laverton grows and develops.

The items covered are random to give a broad perspective of what is occurring within your town.

#### Opening of Duketon Street



Bollards have been removed from the bottom end of Duketon Street. This section will be sealed in November 2023. There is no real reason to keep Duketon Street closed and the flow of traffic behind the War Memorial will be controlled as Laver Park will also be renovated.

Widening of Cox Street



Widening of Crawford Street



These roads will be sealed in November 2023.

Please note that property access along Creation Street and beyond will only have access along Creation to Crawford Streets.

The Racecourse Rd, Merolia Rd and Tip Rd will all be upgraded for sealing in November 2023

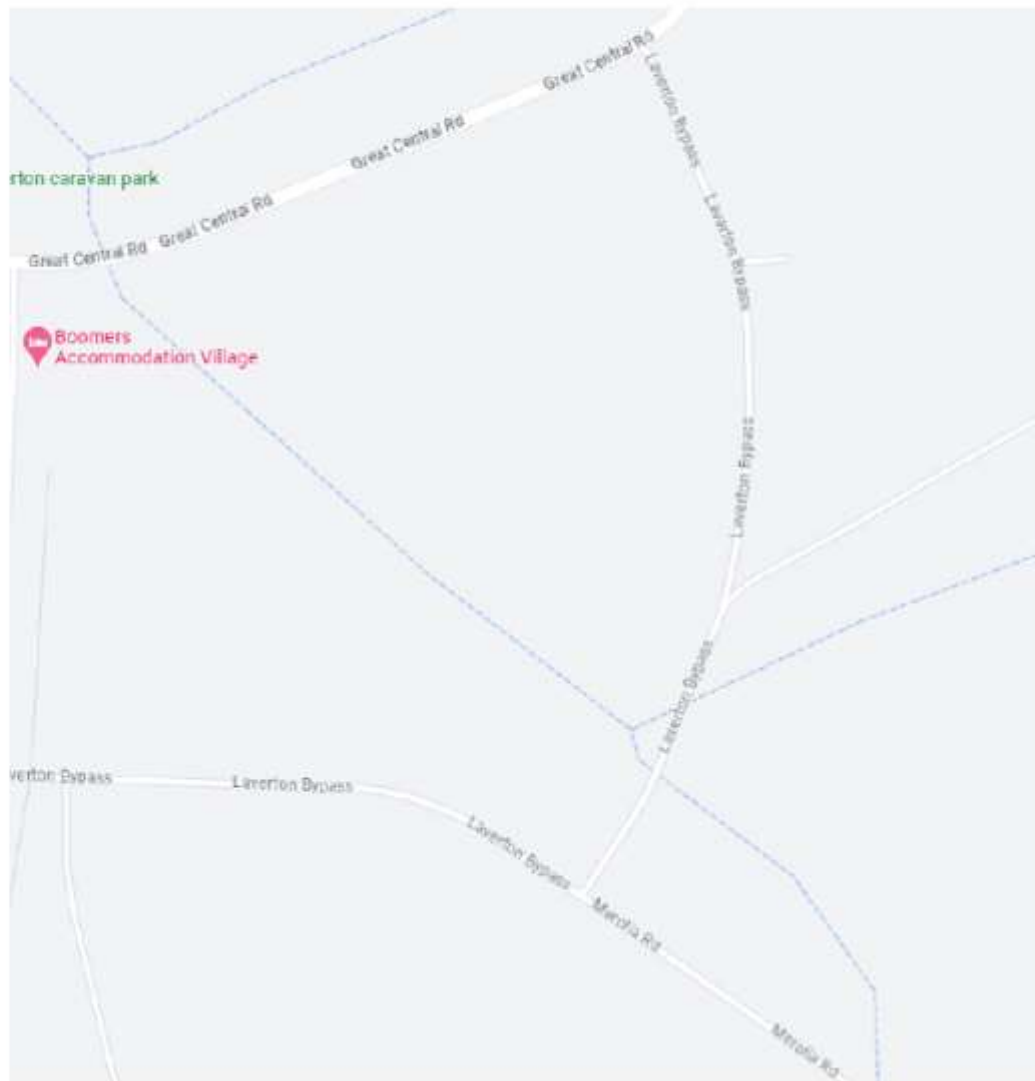

## Roundabout







The fake grass has been removed and replaced with the planting of Gazanias which have been chosen for both its beauty and hardiness.



Laverton/Leonora Road from Cox Street to the roundabout

Trees at an advanced stage will be planted to enhance the entrance (Western) into town to replace trees removed over the years. Behind the trees, bollards will be installed to prevent drivers crossing areas and to enhance and direct traffic safety entering roads.

#### Median Strips

- Duketon Street
- Burt Street
- Hawks Place
- Lancefield Street
- Erlistoun Street

These areas will be planted with Kurrajong trees to provide shade and green the town.

The Council is also considering the continual planting of Kurrajong trees and other selected species on the street verges around the town. Further tree plantings will occur around the town oval. Further information to be provided.

#### Coach House Wall Removal

The Council is considering the removal of the wall around the Old Coach House due to the integrity of the wall.

In addition, the entrance to the Community Resource Centre will be moved to the Laver Place entrance, across from the Swimming Pool.

Before



After



#### Old Youth Centre

This will be a two-stage removal, stage 1, the fencing will be removed and a general clean-up of the site. Stage 2 will be the building itself which includes asbestos removal. This building and fencing are unsightly in the character of Laverton and should not impede the forward improvement of the town. The aim is to open up the town and remove unsightly structures within the main street.





### Airport Upgrade

The Council has authorised the purchase of the attached buildings to replace the existing terminal.

These buildings will be modular in their fabrication and will also include the complete coverage of these buildings by a large roof. The buildings have been designed for practicality and to also allow for further development should the need arise in the future.

The buildings will be built over the existing carpark area so that the operations of the airport are not affected whilst the new buildings are put in place.

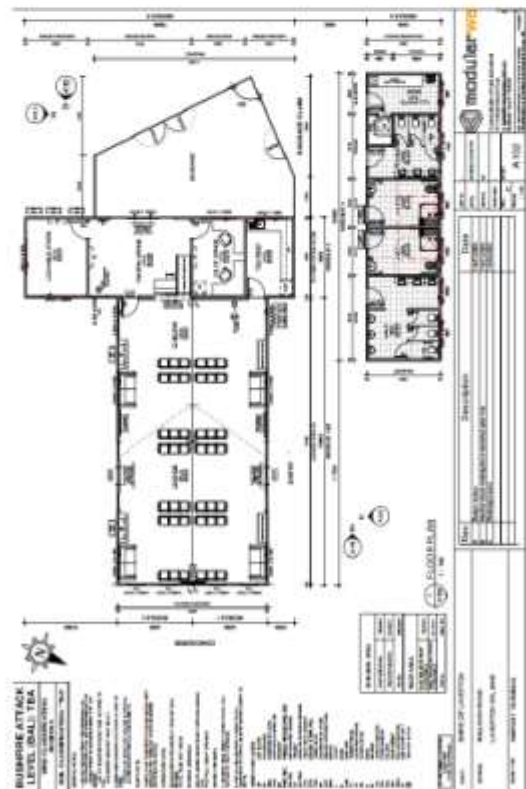
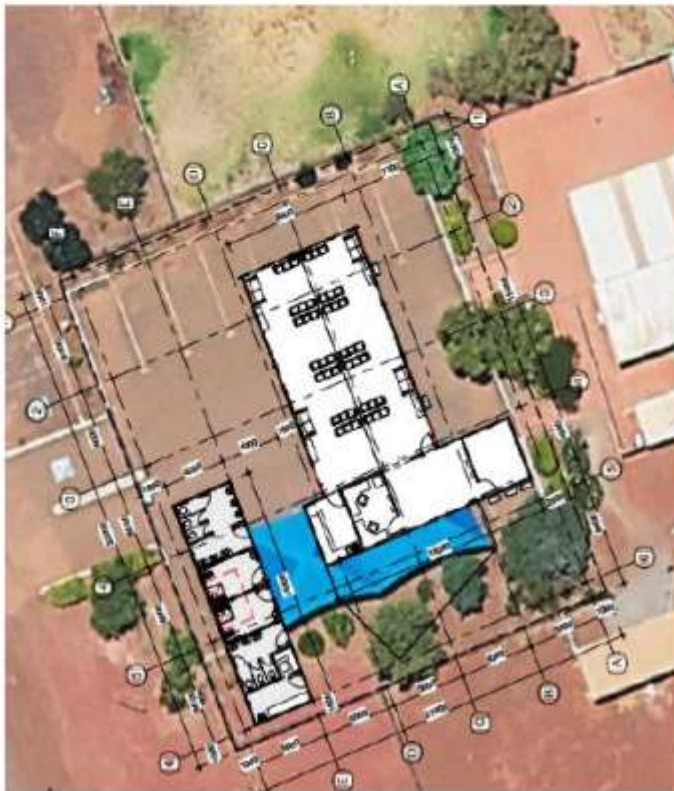



The Council is also undertaking a completed reseal of the runway, apron, and taxiway areas and the construction of turning nodes.

#### Reticulation of areas

The Council has undertaken a comprehensive replacement/upgrade of existing watering of gardens, lawns etc following an investigation into the overall watering of these areas.

The Council waters numerous areas by hand and the maintenance costs have escalated and the waste of water is noticeable.

The following areas will be receiving upgrades:

- Laver Place
- Leahy Place - War memorial
- Oval



- Old CDC building



- Roundabout



o

#### Racecourse



#### Housing

The Council due to shortage of homes within the town has approved a budget allocation of \$2.5 million to build new homes and can be allocated to various government departments to assist in the attraction of new staff to service the town.

In addition, the housing can be added to the council stacks to ensure that it is an incentive to attract staff to Laverton.

#### Youth

The Council has tried on several occasions to attract youth development to the town without success. The Council has been working with a statewide group to provide services for the youth over weekends. The Council will keep everyone informed as the contract is being formulated. It is not all about sport and the aim is to ensure that the youth of the town are afforded daily life skills.

The Council currently have an agreement with the Stephen Michael foundation and the high school and the Council will be looking at continuing that program for 2024.

### The Oval

Please see following plan which is in development and any comments would be appreciated.

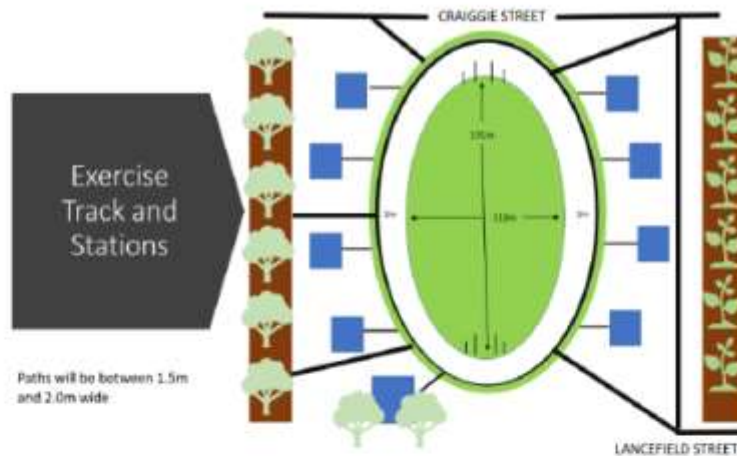

### Fitness Equipment for Exercise Stations



## The Playground

The following additional equipment is to be purchased along with the increase of shade structures and soft fall.

## Proposed Layout of Playground

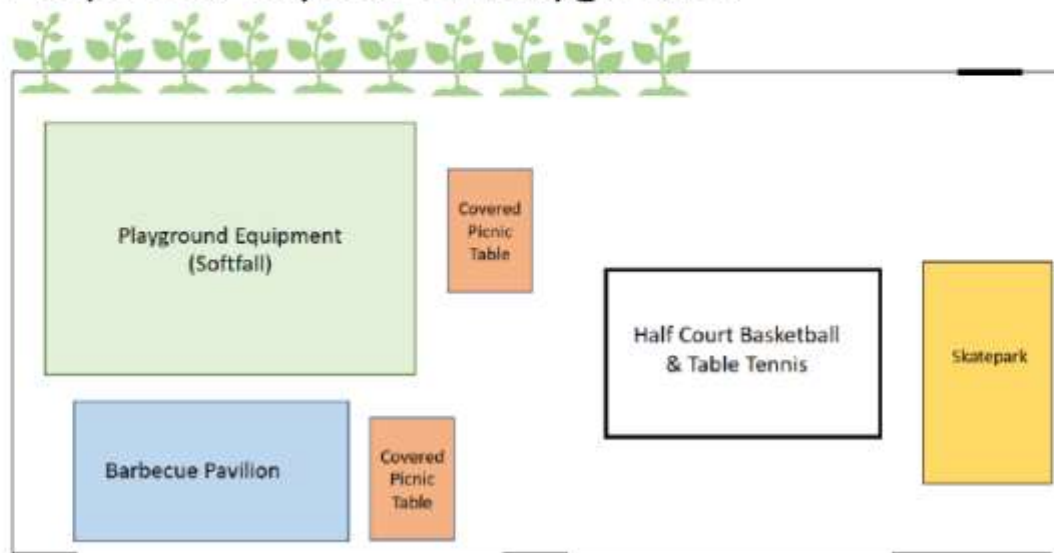

### Basketball Court Area

Existing basketball court to have surface coated and remarked and be converted into a half court and basketball / netball hoops replaced



### Playground Equipment

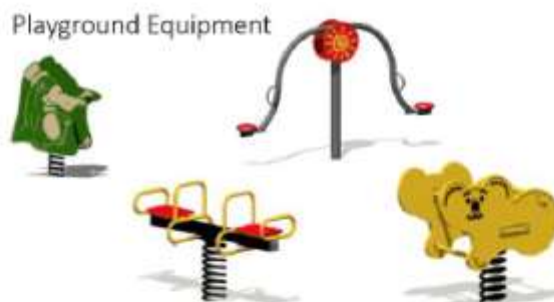

Please let us have any comments which you may have.

These areas will assist in making a complete recreation precinct around the oval and to add that the current skate track will be taken to the west of the current old basketball court.



### Community Garden

The aim is to develop a community garden and further details will be provided as this develops.

Please do not hesitate to contact Phil Marshall in the office on (08) 9031 1202 should you have any questions.

**PHIL MARSHALL  
CHIEF EXECUTIVE OFFICER  
SHIRE OF LAVERTON**

# MURDOCH UNIVERSITY STERILISATION PROGRAM

Veterinary students from Murdoch University, under the guidance of a senior veterinarian, will be travelling to the Shire of Laverton to perform sterilisations, pet checks, and microchips for registered dogs and cats in the Shire of Laverton.

**Thursday 16th November 2023**

**Time: 8:30am to 5:30pm**

**Friday 17th November 2023**

**Time: 7:30am to 5:30pm**

## Vaccination costs

**Vaccinations are free for pets being sterilised  
\$50 for Non Concession card holders**

Murdoch students will carry out sterilisation and pet checks for **cats and dogs free of charge** to residents of Laverton.

Registrations are to be paid for by the owner prior to surgery, or on the day, and a registration tag will be issued.



CASH and EFTPOS accepted at the venue on the day.



Please contact the Shire by 14th November 2023 if you are interested in having your pet sterilised and microchipped.

There are limited sterilisation opportunities available.

For further information please call the Shire office on 90311202

## **Venue: Laverton Shire Hall**

**NOTE: From 1st November 2013 ALL cats must be sterilised, microchipped and registered.  
From 1st November 2015 ALL dogs must be microchipped and registered.**

**ADVERTISE YOUR BUSINESS IN THE LOCAL**

# STURT PEA MAGAZINE

Did you know that for a small fee you can advertise in the local monthly magazine?

Did you know if you are a local not-for-profit organisation you might qualify to advertise for free?

Did you know the Laverton Sturt Pea Magazine is distributed in hard copy format as well as electronically?

Did you know the staff at the Laverton Community Resource Centre can assist in designing your advertisement?

## STURT PEA ADVERTISING PRICE LIST

- A4 FULL PAGE COLOUR: \$40.00
- A4 FULL PAGE B/W: \$25.00
- A4 HALF PAGE COLOUR: \$22.00
- A4 HALF PAGE B/W: \$13.00

**IF YOU WOULD LIKE TO DISCUSS  
ADVERTISING, CONTACT THE LAVERTON  
COMMUNITY RESOURCE CENTRE**

**CRCASSIST@LAVERTON.WA.GOV.AU  
(08) 9031 1800**

**SHOP 4, LAVER PLACE, LAVERTON, 6440**





# CRC NEWS

## Welcome to the October Sturt Pea!

WOW! Can you believe its already October? Please keep your eyes peeled for all the Christmas activities coming up in the next two months, we have some exciting things planned!

The Laverton CRC in conjunction with Water Corp are once again offering FREE shower head swaps! There are two different types of shower heads to choose from - please visit the CRC with your old shower head and find out more info!

Our Seniors Morning teas are going strong! With new faces and familiar. we are welcome to any seniors in town so if you feel like playing bingo and having a cuppa, laughs and some cakes please come along! We have some exciting special guests visiting in the upcoming months!!!

Don't forget! The CRC has FREE Rapid Antigen Tests, Face masks AND soap available for community, perfect for the upcoming winter months. Pop into the CRC to get yours today!

The CRC will be operating limited hours from the 6th of October till 23rd of October. Please ensure that you visit us as early as possible the day during these dates to make sure you are able to get all the help you need!

I hope everyone has a lovely month!

Enjoy the read,  
Jezaire Kelly  
Co-Ordinator, Laverton Community Resource Centre

hello  
OCTOBER



### Disclaimer

The information in this publication is of a general nature and is provided as a service to the community. No responsibility is accepted for the accuracy of this information. The Editor of the Sturt Pea reserves the right to reject or not publish any material which may be scandalous or offensive to any person. No liability will be accepted by the Editor for any statements of opinion, error or omission.

Please email your submissions to [crcassist@laverton.wa.gov.au](mailto:crcassist@laverton.wa.gov.au).

Contact :  
10 Laver Place  
Laverton, WA, 6440  
[laverton@crc.net.au](mailto:laverton@crc.net.au)  
(08) 9031 1800

If you would like a copy of the Sturt Pea magazine emailed through to you each month, please email request through to [crcassist@laverton.wa.gov.au](mailto:crcassist@laverton.wa.gov.au). Alternatively the monthly magazine can be viewed online through the Shire of Laverton website, [www.laverton.wa.gov.au](http://www.laverton.wa.gov.au).



# LAVERTON COMMUNITY RESOURCE CENTRE OPENING HOURS

THE CRC WILL BE OPERATING LIMITED HOURS OVER THE NEXT  
TWO WEEKS FROM MONDAY 9TH OCT TILL MONDAY 23RD OCT!

**MONDAY 9TH /  
TUESDAY 10TH  
OCTOBER**

**09.00AM - 04.00PM**

**WEDNESDAY 11TH /  
THURSDAY 12TH / FRIDAY  
13TH OCTOBER**

**9:00AM-2:30PM**

**MONDAY 16TH / TUESDAY  
17TH / WEDNESDAY 18TH /  
THURSDAY 19TH OCTOBER**

**9:00AM-3:00PM**

**FRIDAY 20TH OCTOBER**

**9:00AM-4:00PM**

**MONDAY 23RD OCTOBER**

**9:00AM-4:00PM**



## *We are your Local:*

- DEPARTMENT OF TRANSPORT AGENT
- FREE GOVERNMENT ACCESS POINT + FREE GOVERNMENT PRINTING!
- LOCAL LAVERTON LIBRARY - MONTHLY STATE LIBRARY OF WA BOOK EXCHANGE
- INTERNET ACCESS
- VIDEO CONFERENCING ROOM + EQUIPMENT AVAILABLE FOR HIRE AND USE
- WIDE RANGE OF SECRETARIAL SERVICES
- + MANY MORE!



COME IN AND SEE US TODAY!  
9:00AM-4:00PM / MONDAY - FRIDAY

CRCASSIST@LAVERTON.WA.GOV.AU  
08 9031 1800

SHOP 4, LAVER PLACE, LAVERTON,  
WESTERN AUSTRALIA, 6440  
WE ARE LOCATED IN THE OLD COACH  
HOUSE BUILDING!



# The **GREAT BEYOND** VISITOR CENTRE



## **OPENING HOURS**

**Monday to Friday**  
**9.00am - 4.30pm**

**Saturday, Sunday & Public**  
**Holidays**  
**9.00am - 1:00pm**

THE GREAT BEYOND VISITOR CENTRE

**Open 7 Days a week**

Phone: (08) 9031 1361

Email: [greatbeyond@laverton.wa.gov.au](mailto:greatbeyond@laverton.wa.gov.au)





# LAVERTON SPORTS CLUB OPENING HOURS

6:00pm – 8:30pm

**MONDAY  
TUESDAY**

**&**

**THURSDAY  
FRIDAY**

Laverton Sports Club  
Weld Drive, Laverton  
E: [lavertonsportsclub@outlook.com](mailto:lavertonsportsclub@outlook.com)





# GREAT CENTRAL RECYCLE



GCR will be servicing the Laverton to Warburton region monthly, representing Containers for Change, a recycling initiative converting containers bound for landfill into 10c per eligible container. In conjunction with the Laverton Sports Club, GCR will be working to encourage as many individuals, businesses large and small and other entities to actively participate in the collection of eligible containers.

For more information or to register your interest  
please email [info@greatcentralrecycle.com.au](mailto:info@greatcentralrecycle.com.au)

For further information on the  
Containers for Change initiative see  
[www.containersforchange.com.au/wa](http://www.containersforchange.com.au/wa)

## Catholic Diocese of Geraldton W A



A Message from the Catholic Parish of  
Church of the Resurrection, Laverton  
Our next Mass will be Saturday the  
21<sup>st</sup> October 6.00pm  
You are most welcomed to join us

In the Old Court House which borders the Town  
Oval, in Craiggie Street Laverton.

The Catholic Parish of Laverton is linked to the Parish of Our Lady of  
Mt Carmel and there may be times, due to sickness or road condi-  
tions where I may not be able to celebrate the Eucharist so I ask that

**you please contact Fr Robert O'Bryan on 0457980852; Email:**

**olmcchurch@westnet.com.au**

Kindest Regards

(Fr.) *Robert O'Bryan*





## FAMILY FUN

# MENZIES Discovery Day

JUMPING CASTLES • STALLS • MUSIC  
FOOD TRUCKS • FACE PAINTING  
GAMES • WATER PLAY  
LAKE BALLARD HELICOPTER RIDES  
AND MORE  
FUN FOR THE WHOLE FAMILY

---

Saturday 14 October 2023  
12noon to late

---

Want to have a stall?  
Call Debbie on 9024 2702

---

Book your Lake Ballard flights today  
<https://circlehelicopters.com.au>  
7 mins \$99 pp / 15 min \$205 pp / 30 min \$375 pp

---

Visit [www.menzies.wa.gov.au](http://www.menzies.wa.gov.au)  
for more information







# CHAMPAGNE BREAKFAST



**The Desert Inn Hotel**  
Sunday 29th October 2023  
9:30am -11:30am

**ALL YOU CAN EAT**  
**Big buffet breakfast**  
\$30 per person

**First glass of champagne or mimosa on  
us to kick start your day**

**Tickets available to buy until 21/10/23**



# Minara Community Foundation Grant Applications

MINARA

COMMUNITY FOUNDATION



## Supporting Community Projects

Read the *Grant Guidelines* and complete the *Grant Application Form* available at [www.glencore.com.au/mcfapplication](http://www.glencore.com.au/mcfapplication)

Minara Community Foundation  
c/o Minara Resources (08) 9212 8400

Email: [mcf.minara@glencore.com.au](mailto:mcf.minara@glencore.com.au)

We welcome the opportunity to discuss your grant application and encourage you to please contact us for assistance.

Minara Community Foundation 2023 grant applications are now open.

We invite local community groups and organisations to apply for funding by Thursday, 12<sup>th</sup> October 2023.

Consideration will be given to a wide range of projects in the Shires of Laverton, Leonora and Menzies.

Ideally, projects should commence by April 2024.

Grant applications of up to \$100,000 will be considered. Smaller projects are also encouraged to apply (e.g. less than \$10,000).

### Applications close

Thursday, 12<sup>th</sup> October 2023

## We Support

- Education, including training.
- Health and other social benefits.
- Economic development.
- Environment.
- Programs and initiatives for youth and future generations.
- Culture and heritage, including the preservation of Indigenous culture.





# Centrecare Outreach



**CENTRECARE**  
*"People Making Time for People"*

**LAVERTON**

**Centrecare services will be available in Laverton  
every **Wednesday** from 12 - 3:30pm  
at the Community Resource Centre**

**GP Referrals, Provisional and Self-Referrals accepted.**

**For more information, please contact (08) 9080 0333 or  
email [kalgoorlie@centrecare.com.au](mailto:kalgoorlie@centrecare.com.au)**

[www.centrecare.com.au](http://www.centrecare.com.au)



Term Planner 2022 Term Four

 <b>LAVERTON SCHOOL</b>					
	Monday	Tuesday	Wednesday	Thursday	Friday
1 FB ADMIN	9 <sup>th</sup> Oct <b>PUPIL FREE DAY</b>	10 <sup>th</sup> Oct YUGA QUEEN	11 <sup>th</sup> Oct Stephen Michael (Aaron to run)	12 <sup>th</sup> Oct Play Group Career's expo Leonora DREAM • ASPIRE • ACHIEVE	13 <sup>th</sup> Oct
2 FB POST Attend Officer	16 <sup>th</sup> Oct	17 <sup>th</sup> Oct	18 <sup>th</sup> Oct Stephen Michael (Perth team to run)	19 <sup>th</sup> Oct Play Group	20 <sup>th</sup> Oct
3 FB POST RM 8	23 <sup>rd</sup> Oct	24 <sup>th</sup> Oct	25 <sup>th</sup> Oct Stephen Michael (Perth team to run)	26 <sup>th</sup> Oct Play Group	27 <sup>th</sup> Oct <b>Years 7-9 Assembly</b>
4 FB POST RM 2	30 <sup>th</sup> Oct	31 <sup>st</sup> Oct <b>Halloween</b>	1 <sup>st</sup> Nov Stephen Michael (Aaron to run)	2 <sup>nd</sup> Nov Play Group	3 <sup>rd</sup> Nov <b>School Council Meeting</b>
5 FB POST RM 3	6 <sup>th</sup> Nov	7 <sup>th</sup> Nov	8 <sup>th</sup> Nov Stephen Michael (Perth team to run)	9 <sup>th</sup> Nov Play Group	10 <sup>th</sup> Nov
6 FB POST RM 6	13 <sup>th</sup> Nov	14 <sup>th</sup> Nov	15 <sup>th</sup> Nov Stephen Michael (Aaron to run)	16 <sup>th</sup> Nov Play Group	17 <sup>th</sup> Nov <b>Room 6 Year 11 &amp; 1's</b>
7 FB POST RM 5	20 <sup>th</sup> Nov	21 <sup>st</sup> Nov	22 <sup>nd</sup> Nov Stephen Michael (Perth team to run)	23 <sup>rd</sup> Nov Play Group	24 <sup>th</sup> Nov
8 FB POST Steph Michael	27 <sup>th</sup> Nov TLG	28 <sup>th</sup> Nov	29 <sup>th</sup> Nov Stephen Michael (Aaron to run)	30 <sup>th</sup> Nov Play Group <b>Finance Committee Meeting</b>	1 <sup>st</sup> Dec <b>School Council Meeting</b>
9 FB POST SSTARS	4 <sup>th</sup> Dec	5 <sup>th</sup> Dec	6 <sup>th</sup> Dec Stephen Michael Perth team to run	7 <sup>th</sup> Dec Play Group <b>Whole school (night-time) End of Year Assembly</b>	8 <sup>th</sup> Dec <b>Swimming Carnival</b> (Royal Life Saving W.A. to support)
10 FB POST ADMIN	11 <sup>th</sup> Dec	12 <sup>th</sup> Dec <b>Reports to go home</b>	13 <sup>th</sup> Dec Stephen Michael (Perth team to run) Attendance Reward Class Parties	14 <sup>th</sup> Dec Play Group	15 <sup>th</sup> Dec <b>PUPIL FREE DAY Last Day of School</b>

## Want to run your own business?

**Many Rivers' business coaches work with you to set up, start and sustain your business.**

**Do you want to start a business? Give me a call today!**



### Get in touch

Your local business coach in  
The Goldfields is Shaun Atkinson

**Hi, I'm Shaun, your local business coach.**

As a previous business owner, I know the challenges and benefits of running your own small business and I would like to help you to achieve your business goals.

### **MANY RIVERS CAN SUPPORT YOU BY**

- Assisting you to develop a strong business idea
- Remaining by your side as you build the business skills and confidence to make your idea a reality
- Preparing you with the tools you need to run your business such as legal support or business finance

**Contact us for more information**

0477 736 266 | [shaun.atkinson@manyrivers.org.au](mailto:shaun.atkinson@manyrivers.org.au)  
[www.manyrivers.org.au](http://www.manyrivers.org.au)

**MANYRIVERS**





**LAVERTON SPORTS CLUB**

# DARTS

**STARTS ON  
THURSDAY 16TH  
FEBRUARY  
7pm start**

**ENTRY FEE: \$5 PER PERSON**  
**Randomly Drawn Teams on**  
**the night.**

**Darts is every Thursday except**  
**the last week of each month,**  
**where darts will be played on a**  
**FRIDAY with a bbq supper**

**MEMBERS MUST SIGN GUESTS IN**  
**NEW MEMBERS WELCOME.**

**Email: [lavertonsportsclub@outlook.com](mailto:lavertonsportsclub@outlook.com)**



**Do you need driving lessons  
or  
Do you need to get your log  
book hours up?**



**WE CAN HELP**

- ◊ Experienced Qualified Driving Instructor
  - ◊ Flexible hours
  - ◊ Young and old Clients welcome
- ◊ Affordable Rates (Free for students & CDP participants)
  - ◊ LCCA Driver Vehicle supplied

Contact the LCCA on (08) 9031 1395 for more information  
or to Book a driving session.

LCCA/Laverton Gallery—cnr Augusta & Euro Sts





## Laverton Aboriginal Art Gallery

Managed by

LAVERTON CROSS CULTURAL ASSOCIATION INC.

### Genuine Aboriginal Art

By Artists from Laverton and the Western Desert area

**Come and see the outback through the eyes of local Aboriginal artists at Laverton Gallery. Each of the original artworks is unique and tells the stories of this beautiful country.**

➤ **Eftpos facilities**

➤ **Secure payments**



The Laverton Gallery was established to display, promote and sell authentic Aboriginal art on behalf of artists from Laverton & the Western Desert.

**Email:** [lavertonlcca@outlook.com](mailto:lavertonlcca@outlook.com) | **Phone:** (08) 9031 1395

Cnr of Euro & Augusta St, Laverton W.A 6440 | P.O Box 123, Laverton W.A 6440





**PLUMBING & GAS | AIR CONDITIONING | VACUUM TRUCK**

**NORTHERN AND SOUTHERN GOLDFIELDS**

**0487 207 510**

PL 9425 AU 50818 T 01168

**DOMESTIC | COMMERCIAL | MINING**



## **WASTE REMOVAL SERVICES**



- Septic tanks
- Ablution blocks
- Port a-loos
- Grease traps
- Wash pads
- Fuel bays
- Waste oils
- Mud and more!

## **AIR CONDITIONING SERVICES**

- Split systems
- Evaporatives
- Window rattlers
- Repairs
- Servicing
- Installations
- Replacements







# DESERT SANDS

## CARTAGE CONTRACTORS

Est. 1989

- Premix • Blue Metal
- Screened Sands
- Portable Water Supply Cartage



- Bulk Tipper Haulage
- Screened River Rock
- Loader Hire • Float Hire
- Bulk Fuel Haulage
- Concrete Supplies to Remote Areas
- Heavy Duty Mechanical Repairs & Field Service
- Distributors of Fresh Drinking Water



**LAVERTON**  
**WESTERN AUSTRALIA**  
**Ph: (08) 9031 1326**



**site@desertsands89.com.au**  
**www.desertsandscartage.com.au**



Desert Sands Cartage Contractors Laverton WA  
EST.1989



**\*\*New Season\*\*** Oaten Hay Bales for Sale \$140.00 each +gst  
Please call or email before pick up at Lot 501 Cox Street Laverton WA  
Email [site@desertsands89.com.au](mailto:site@desertsands89.com.au) or Phone 08 9031 1326

## Tax returns

CBSL ACCOUTANTS CBSL ACCOUTANTS CBSL ACCOUTANTS CBSL ACCOUTANTS

### BOOK YOUR TAX RETURN APPOINTMENT NOW!

Laverton Appointments available with Ross Norrie CPA each Friday from 14<sup>th</sup> July 2023

- Appointments are essential to avoid delays
- Your Income Statement should be "Tax Ready" on MyGov before your appointment
  - Request a Checklist so you bring everything needed to your appointment
  - Reasonable fees starting from \$145 for a basic Return
- Cash or card payment options available or our fee can be taken from your refund



**Hourly appointments available each Friday,  
between 9am and 6pm,  
at the  
Volunteer Fire & Rescue Building  
in Euro Street, Laverton**



Call 08) 9037 6777 to book now or Email [receptionCBSL@outlook.com](mailto:receptionCBSL@outlook.com) for a Checklist

"Your Accounting and Taxation Consultants in the North Eastern Goldfields – Leonora, Laverton & Leinster"

CBSL ACCOUTANTS CBSL ACCOUTANTS CBSL ACCOUTANTS CBSL ACCOUTANTS





Government of Western Australia  
WA Country Health Service

# Commonwealth Home Support Program (CHSP) in Laverton

**CHSP provides support services to older people to help them to continue to live independently in their own homes and in the community**

Services include: meal delivery or preparation assistance, help with showering or personal care, house cleaning, laundry, local transport, shopping, activity days, home maintenance and social support.

## Get in touch

The WA Country Health Service provides CHSP services in your area and will help you with your My Aged Care application.

For more information please phone:  
Laverton CHSP Office on 9088 2600  
To find out more you can also visit the  
My Aged Care website  
<https://www.myagedcare.gov.au/> and  
click on the 'Find and set up services'  
button.

To provide feedback on this publication email  
wechscomms@health.wa.gov.au. Alternative formats can  
be provided on request. © WA Country Health Service.







# VOTE

# 1

# COUNCILLOR GARY BUCKMASTER

*Trustworthy & Experienced*

# VOTE

# 1



Gary John Buckmaster  
12 Boomerang Street  
Laverton WA 6440  
Mobile: 0427 476 474

Having served on Council since 2019, I would be honoured to have the opportunity to serve the people of Laverton for another four year term.

I am a local contractor with over 40 years experience in the Building and Construction industry. I came to Laverton in 2012 as a Construction Supervisor for the building of the Stage 2 Lynas Plant project. I then decided to settle in Laverton and enjoy the desert lifestyle and its people.

Being a homeowner and resident in the town of Laverton, I would strongly support and campaign for the following:

- Better Health & Aged Care facilities
- Ongoing beautification of the town
- Community gardens and landscapes
- Better recreation areas and public facilities, including skate park & playgrounds
- Walking/Bike tracks for tourists and local residents
- Community based events
- Tourist attracting projects
- Community Safety & Wellbeing
- Preservation and improvements on historical and cultural heritage

I believe that being a Councillor that actually lives in Laverton permanently gives me a better understanding of the day to day needs of the town. I would feel privileged to continue being a representative of the community.

Authorised by Gary Buckmaster.

*Trustworthy & Experienced*

## COUNCILLOR GARY BUCKMASTER

# REX



# UNITY

# VOTE

# 1



19 MORGANS STREET  
LAVERTON, 6440

OFFERED AT  
\$220,000

For **SALE**



- 3 BEDROOMS
- 2 BATHROOMS
- BELOW GROUND POOL
- FULLY FENCED BLOCK WITH 6  
SECURE CAR PARKING
- FIRE PIT
- EASY FLOW THRU FLOOR PLAN
- WOODGRAIN FLOORS
- MODERN WELL-EQUIPPED  
KITCHEN
- DISHWASHER
- SPLIT SYSTEM AIR-  
CONDITIONING
- 2 DOUBLE DOOR PANTRY'S
- SHADY ENTERTAINING PATIO
- ESTABLISHED LAWNS AND  
GARDENS
- BLOCK SIZE 675M2

A PLACE TO CALL

*home!*

Walk in-Walk out, Furniture is  
staying!

Stylish renovated modern  
family home ready for the  
buying!



Jade the Realtor  
Senior Sales Executive

M 0496 204 561 | E [Jade.Torsua@kalgoorliemetro.com.au](mailto:Jade.Torsua@kalgoorliemetro.com.au)

**KALGOORLIE  
METRO**  
PROPERTY GROUP

[kalgoorliemetro.com.au](http://kalgoorliemetro.com.au)  
40 Brooker Street, Kalgoorlie WA 6430

### Outreach Schedule CMHS July 2023 – December 2023

<b>July 2023</b>	<b>Kalgoorlie - Leonora –</b> - Mon 17 <sup>th</sup> July 2023- arrive @ 12.30pm <b>Leonora – Laverton - Leonora</b> – Tue 18 <sup>th</sup> July 2023 <b>Leonora - Kalgoorlie</b> – Wed 19 <sup>th</sup> July 2023 - Leave @ 12.30pm
<b>August 2023</b>	<b>Kalgoorlie - Leonora –</b> - Mon 14 <sup>th</sup> August 2023- arrive @ 12.30pm <b>Leonora – Laverton - Leonora</b> – Tue 15 <sup>th</sup> August 2023 <b>Leonora - Kalgoorlie</b> – Wed 16 <sup>th</sup> August 2023 - Leave @ 12.30pm
<b>September 2023</b>	<b>Kalgoorlie - Leonora –</b> - Mon 18 <sup>th</sup> September 2023- arrive @ 12.30pm <b>Leonora – Laverton - Leonora</b> – Tue 19 <sup>th</sup> September 2023 <b>Leonora - Kalgoorlie</b> – Wed 20 <sup>th</sup> September 2023 - Leave @ 12.30pm
<b>October 2023</b>	<b>Kalgoorlie - Leonora –</b> - Mon 16 <sup>th</sup> October 2023- arrive @ 12.30pm <b>Leonora – Laverton - Leonora</b> – Tue 17 <sup>th</sup> October 2023 <b>Leonora - Kalgoorlie</b> – Wed 18 <sup>th</sup> October 2023 - Leave @ 12.30pm
<b>November 2023</b>	<b>Kalgoorlie - Leonora –</b> - Mon 20 <sup>th</sup> November 2023- arrive @ 12.30pm <b>Leonora – Laverton - Leonora</b> – Tue 21 <sup>st</sup> November 2023 <b>Leonora - Kalgoorlie</b> – Wed 22 <sup>nd</sup> November 2023 - Leave @ 12.30pm
<b>December 2023</b>	<b>Kalgoorlie - Leonora –</b> - Mon 18 <sup>th</sup> December 2023- arrive @ 12.30pm <b>Leonora – Laverton - Leonora</b> – Tue 19 <sup>th</sup> December 2023 <b>Leonora - Kalgoorlie</b> – Wed 20 <sup>th</sup> December 2023 - Leave @ 12.30pm

## **Outreach Mental Health Team :**

Visiting Psychiatrist - TBC

Senior Mental Health Practitioner - TBC

Aboriginal Mental Health Worker – TBC

**PLEASE NOTE THAT OUTREACH SCHEDULE IS  
SUBJECT TO CHANGE BECAUSE OF THE CURRENT  
CLIMATE WE ARE IN IE COVID, ETC**

---

**Aim:** Our aim is to work closely with you and your family to support the transition throughout your journey to wellness.

**What we do:** Our Team provides a culturally appropriate service, using culturally appropriate materials when supporting our clients. We can assist in the following areas :

- Inpatient Care (Kalgoorlie)
- Case Management
- Clinical Support
- Medication Management
- Outreach to Communities
- Aboriginal Mental Health First Aid
- Cultural Awareness
- Psychiatrist Clinic every quarter (Laverton & Leonora).
- Support Community Health Teams
- Support Hospitals & Nursing Posts
- Work with Government , NGO's, Families, Friends & Communities.



## Outreach Schedule CAMHS August 2023 – December 2023

**July**

**No CAMHS Outreach July 2023**

**August  
2023**

**Kalgoorlie - Leonora –**  
– Mon 14<sup>th</sup> August 2023- arrive @ 12.30pm  
**Leonora – Laverton - Leonora**  
– Tue 15<sup>th</sup> August 2023  
**Leonora - Kalgoorlie**  
– Wed 16<sup>th</sup> August 2023 - Leave @ 12.30pm

**September  
2023**

**Kalgoorlie - Leonora –**  
– Mon 18<sup>th</sup> September 2023- arrive @ 12.30pm  
**Leonora – Laverton - Leonora**  
– Tue 19<sup>th</sup> September 2023  
**Leonora - Kalgoorlie**  
– Wed 20<sup>th</sup> September 2023 - Leave @ 12.30pm

**October  
2023**

**Kalgoorlie - Leonora –**  
– Mon 16<sup>th</sup> October 2023- arrive @ 12.30pm  
**Leonora – Laverton - Leonora**  
– Tue 17<sup>th</sup> October 2023  
**Leonora - Kalgoorlie**  
– Wed 18<sup>th</sup> October 2023 - Leave @ 12.30pm

**November  
2023**

**Kalgoorlie - Leonora –**  
– Mon 20<sup>th</sup> November 2023- arrive @ 12.30pm  
**Leonora – Laverton - Leonora**  
– Tue 21<sup>st</sup> November 2023  
**Leonora - Kalgoorlie**  
– Wed 22<sup>nd</sup> November 2023 - Leave @ 12.30pm

**December  
2023**

**Kalgoorlie - Leonora –**  
– Mon 18<sup>th</sup> December 2023- arrive @ 12.30pm  
**Leonora – Laverton - Leonora**  
– Tue 19<sup>th</sup> December 2023  
**Leonora - Kalgoorlie**  
– Wed 20<sup>th</sup> December 2023 - Leave @ 12.30pm

## **Outreach Mental Health Team :**

Ashleigh Jackson -CAMHS (Child) Mental Health Practitioner

TBC - Aboriginal Mental Health Worker









If a Psychiatrist is required a VC will be booked

**PLEASE NOTE THAT OUTREACH SCHEDULE IS SUBJECT TO CHANGE BECAUSE OF THE CURRENT CLIMATE WE ARE IN IE COVID, ETC**

**Aim:** Our aim is to work closely with you and your family to support the transition throughout your journey to wellness.

**What we do:** Our Team provides a culturally appropriate service, using culturally appropriate materials when supporting our clients. We can assist in the following areas :

- Psychiatrist appointments by VC if required
- Case Management
- Clinical Support
- Medication Management
- Outreach to Communities
- Aboriginal Mental Health First Aid
- Cultural Awareness
- Support Community Health Teams
- Support Hospitals & Nursing Posts
- Work with Government , NGO's, Families, Friends & Communities.

MONDAY	TUESDAY	WEDNESDAY	THURSDAY	FRIDAY	SATURDAY	SUNDAY
30						1 Mens Shed 9:00am 
2	3	4	5  DARTS! 7:00PM	6	7	8 Mens Shed 9:00am 
9	10	11	12  DARTS! 7:00PM	13	14	15 Mens Shed 9:00am 
16	17	18	19  DARTS! 7:00PM Ordinary council meeting 5:00pm @ Laverton Council Chambers	20	21 Church 6:00pm 	22 Mens Shed 9:00am 
23	24	25	26 Seniors morning tea! 10am—Laverton CRC 	27	28	29 Mens Shed 9:00am 